

AXYPET-12™ multichannel

Revolutionary Multichannel Manifold

AXYPET™ Multichannels feature a revolutionary suspension system which allows the shafts to retract slightly when they are pressed against a row of pipette tips. Each shafts moves independently, resulting in an even sealing force being applied to all 8 or 12 tips.

With reduced forces being applied, tip sealing pressures are reduced to a minimum and so eliminate the common incidence of tips being jammed on to the pipette shaft.

As a result of these reduced forces, tips can be ejected effortlessly.



REGULAR PIPETTING
action requires forward and backward movement of the thumb

Pipetting action using **EZJECT BUTTON** requires only minimal lateral movement reducing fatigue*

the unique EZJECT

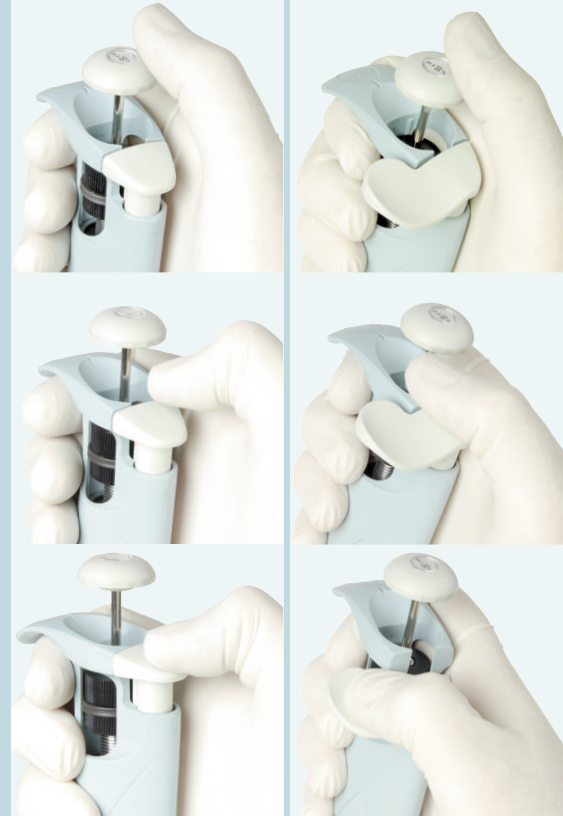

* left handed EZJECT button available on request

each and every AXYPET™ is subjected to a extensive quality/performance checks before it is passed for despatch

Calibrated and issued with a unique individual certificate of accuracy and precision to guarantee the standards set by the manufacturing quality management systems - certified to ISO 9001/2000 - you can absolutely rely on AXYPET™.

All AXYPET™ internal components are engineered to bring a new standard in pipetting performance. All raw materials are carefully selected to guarantee long pipette life even in the most severe environments.

Included in our comprehensive quality procedures:

- Component testing
- Durability testing
- Aging/Transportation testing

For convenience, and to allow AXYPET™ to be maintained in the user's lab, a calibration key is also supplied with every pipette.



AXYPET™ Quality Control Laboratory operates in accordance with ISO 8655 standard.



QUALITY CONTROL CERTIFICATE					
The enclosed liquid handling instrument has been manufactured in a facility that employs a registered and certified quality management system. This system ensures that the development and production of this product has been strictly controlled and that it meets the highest quality standards. Each instrument passes stringent validation and Control Procedures in accordance with EN ISO 8655 and carries the CE mark.					
Model:	AP-100	Volume (µl) :	10.000 Volume (µl) :	100.00	
Serial:	758040001	Accuracy (%) :	-0.273	Accuracy (%) :	-0.025
Cat.No.:	501-06-041	Precision (%) :	0.153	Precision (%) :	0.105
Date:	28.06.07	Status:	Passed	Passed	
Tested by:	C16				
Calibrated and tested using the gravimetric method with distilled water: Condition of measurements: Basis of adjustment: Ex; Reference temperature: 20°C; Relative air humidity: 50%; Barometric pressure: 101kPa					

quality control

user calibration in 4 easy steps



00:00:05

Remove pushbutton set...

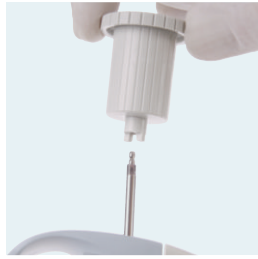

00:00:15

Insert special calibration key
and locate in key slots....

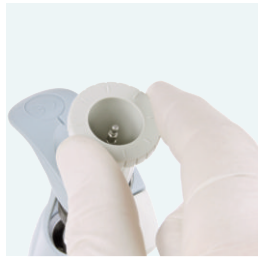

After determining inaccuracy using a
balance (as described in manual)

00:01:45

Turn key to increase or decrease
display volume

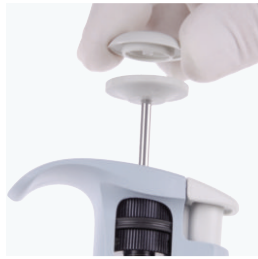

00:02:00

Replace pushbutton set and
procedure is complete

.... procedure can be completed in
less than 2 minutes

Ordering Information and Specifications

Cat. No.	No. of Channels	Volume Range μ l	Accuracy %	Precision %	Uses Tip:
AP-2	1	Min 0.2 1.0 Max 2.0	± 12.0 ± 2.7 ± 1.5	± 6.0 ± 1.3 ± 0.7	T-300 TXL-10*
AP-10	1	Min 0.5 5 Max 10.0	± 4.0 ± 1.0 ± 0.5	± 2.8 ± 0.6 ± 0.4	T-300 TXL-10*
AP-20	1	Min 2 10 Max 20	± 3.0 ± 1.0 ± 0.8	± 1.5 ± 0.5 ± 0.3	TR-222
AP-50	1	Min 5 25 Max 50	± 2.5 ± 1.0 ± 0.8	± 2.0 ± 0.6 ± 0.4	TR-222
AP-100	1	Min 10 50 Max 100	± 1.6 ± 0.8 ± 0.8	± 0.80 ± 0.24 ± 0.20	TR-222
AP-200	1	Min 20 100 Max 200	± 1.2 ± 0.8 ± 0.6	± 0.60 ± 0.25 ± 0.20	TR-222
AP-250	1	Min 50 125 Max 250	± 1.0 ± 0.8 ± 0.6	± 0.4 ± 0.3 ± 0.3	TR-333
AP-1000	1	Min 100 500 Max 1,000	± 1.6 ± 0.7 ± 0.6	± 0.40 ± 0.20 ± 0.15	T-1000 T-1200*
AP-5000	1	Min 1,000 2,500 Max 5,000	± 0.6 ± 0.6 ± 0.5	± 0.25 ± 0.20 ± 0.15	T-5000
AP-10ML	1	Min 1,000 5,000 Max 10,000	± 2.5 ± 0.8 ± 0.5	± 0.6 ± 0.3 ± 0.2	T-10ML

* not used for accuracy and precision data

pipettes



STAND OPTIONS
for safe storage
when not in use

CAROUSEL



LINEAR acrylic

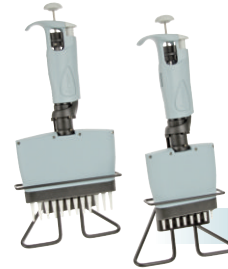

WIRE multi

COLOUR IDENTIFICATION
RINGS ALLOW PIPETTES
TO BE INDIVIDUALISED
FOR USER OR FOR A
SPECIFIC APPLICATION.
AVAILABLE IN 10
COLOURS.

